

ASSEMBLY INSTRUCTIONS

Product parts

- 1 - Long curved section (x2)
- 2 - Top & Bottom horizontal bar (x2)
- 3 - Round corner (x4)
- 4 - Base curved bar short (x2)
- 5 - Base curved bar long (x2)
- 6 - Horizontal narrow tube (x3)

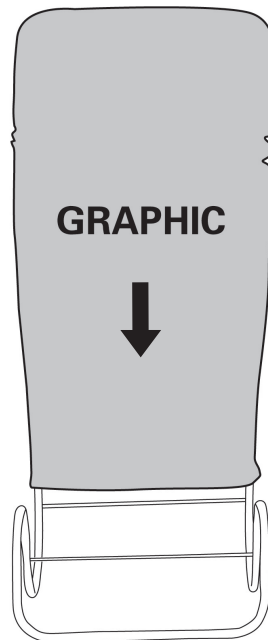
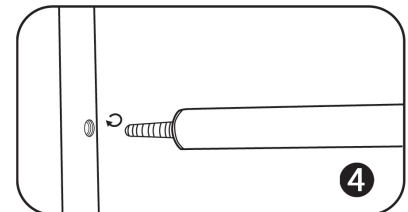
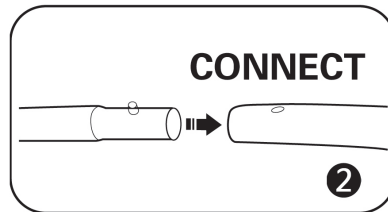
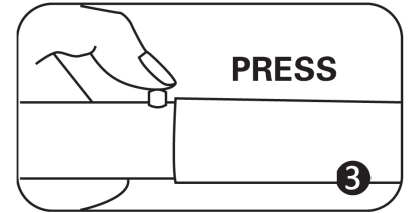
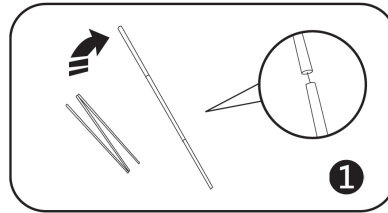
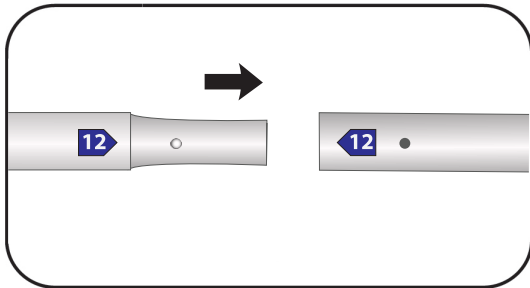
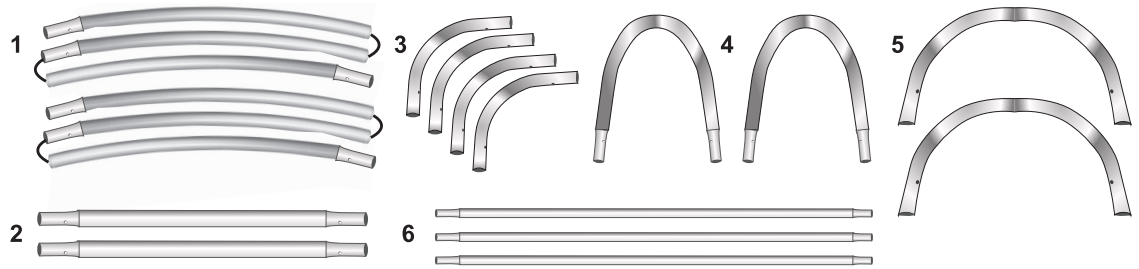

Place all product parts into Carry Case and store in a cool dry location. Recommended for indoor use only. Machine wash on gentle cycle using mild detergent. Tumble Dry No Heat. Do NOT dry clean, Do NOT Iron.